

SUB-ZERO DESIGN GUIDE



SUB-ZERO



MODELS IC-27F, 427G (WINE) AND IC-27R

Integrated Refrigeration. With custom cabinet fronts and hardware, Sub-Zero invented integrated columns, drawers and tall units that disappear into the decor. Integrated units fit flush with other cabinets, making integrated refrigeration as practical and beautiful in the master suite, bar or theatre room as in the kitchen.

INTEGRATED MODELS

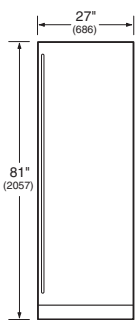

IC-27R
AVAILABLE
2ND QUARTER 2010

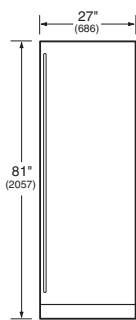

IC-27FI
AVAILABLE
2ND QUARTER 2010

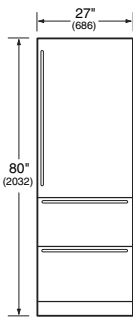

700TR

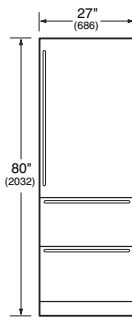

700TFI

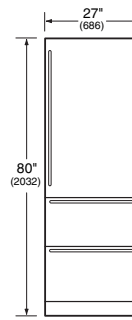

700TCI

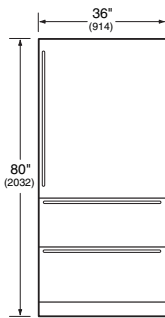

736TR

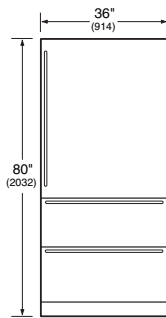

736TFI

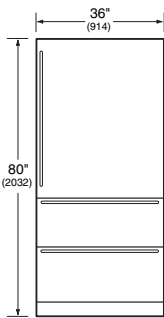

736TCI

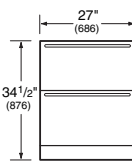

700BR

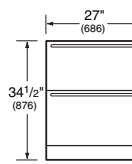

700BF(I)

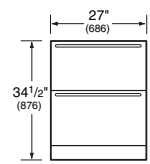

700BC(I)

KEY FEATURES

- Custom cabinet fronts and hardware allow for infinite design options.
- Point-of-use refrigeration that can be placed anywhere in the home.
- Dual refrigeration; two compressors preserve food's goodness in self-contained compartments.
- Energy efficient; many models are ENERGY STAR® qualified.
- Drawer models are Star-K certified.

Overall Dimensions

COLUMN MODELS

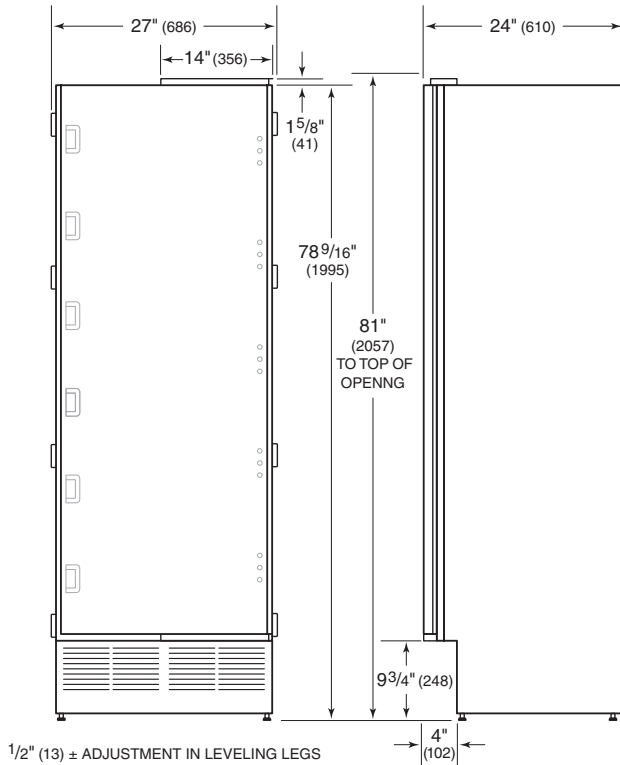

27" (686) TALL MODELS

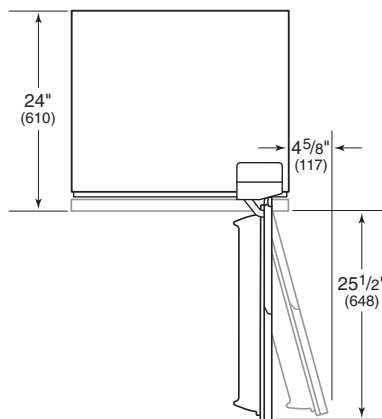
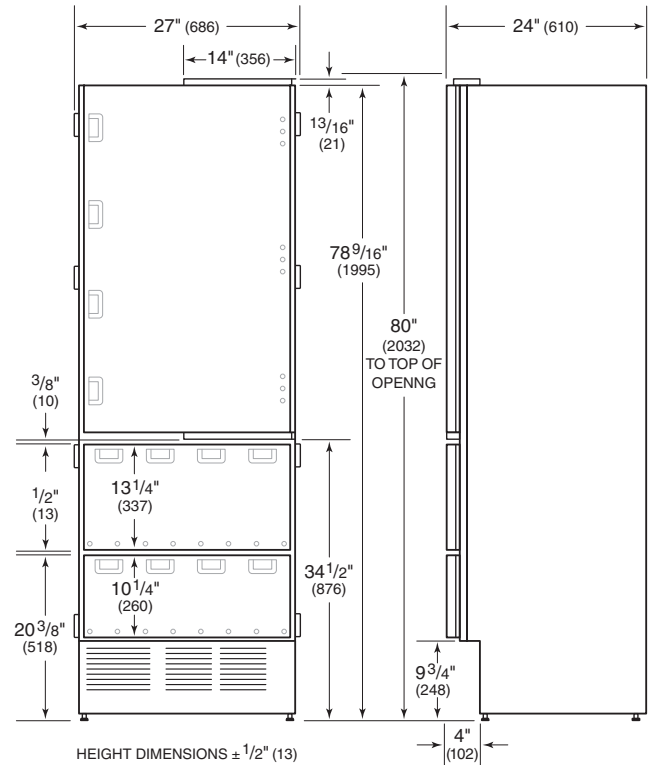

DIMENSIONS WILL VARY WITH PANEL THICKNESS

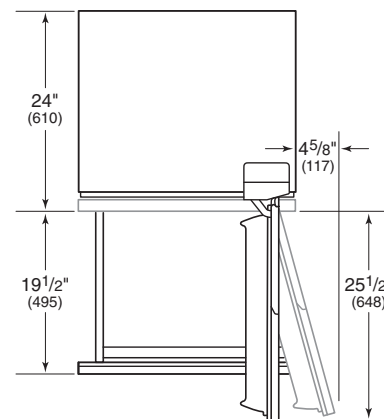

DIMENSIONS WILL VARY WITH PANEL THICKNESS

MODELS IC-27R AND IC-27FI

MODELS 700TR, 700TFI AND 700TCI

Overall dimensions do not include panels or handles.

Overall Dimensions

DRAWER MODELS

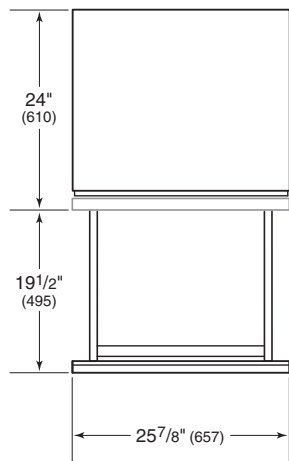
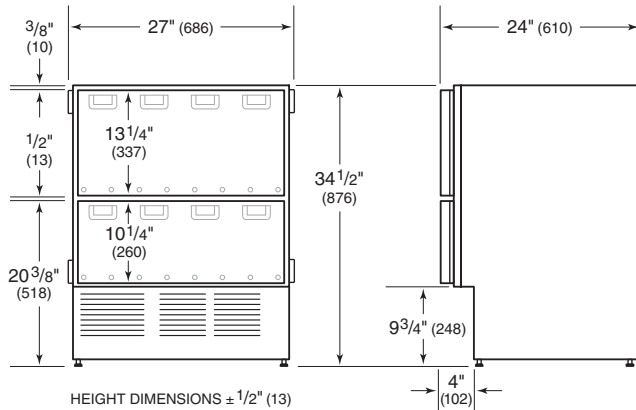

DIMENSIONS WILL VARY WITH PANEL THICKNESS

MODELS 700BR, 700BF(I) AND 700BC(I)

Capacity and Weight

Interior Capacity	R cu ft (L)	F cu ft (L)
COLUMN MODELS		
IC-27R	16.2 (459)	
IC-27FI		16.3 (462)
27" (686) TALL MODELS		
700TR	15.5 (439)	
700TFI		15.3 (433)
700TCI	10.2 (289)	5.1 (144)
36" (914) TALL MODELS		
736TR	20.9 (592)	
736TFI		21.5 (609)
736TCI	13.3 (377)	7.1 (201)
27" (686) DRAWER MODELS		
700BR	5.3 (150)	
700BF(I)		5.1 (144)
700BC(I)	2.9 (82)	2.1 (59)

Shipping Weight	lbs (kg)
IC-27R, IC-27FI, 700TR, 700TFI and 700TCI	360 (163)
736TR, 736TFI and 736TCI	480 (218)
700BR, 700BF(I) and 700BC(I)	190 (86)

Opening Dimensions

INTEGRATED MODELS

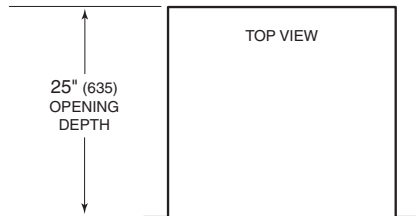

IMPORTANT NOTE: The depth of each integrated model is 24" (610) from the front of the unit to its back. Your design may necessitate moving the unit back or cabinets forward to achieve a flush fit. This will require a minimum rough opening depth of 25" (635).

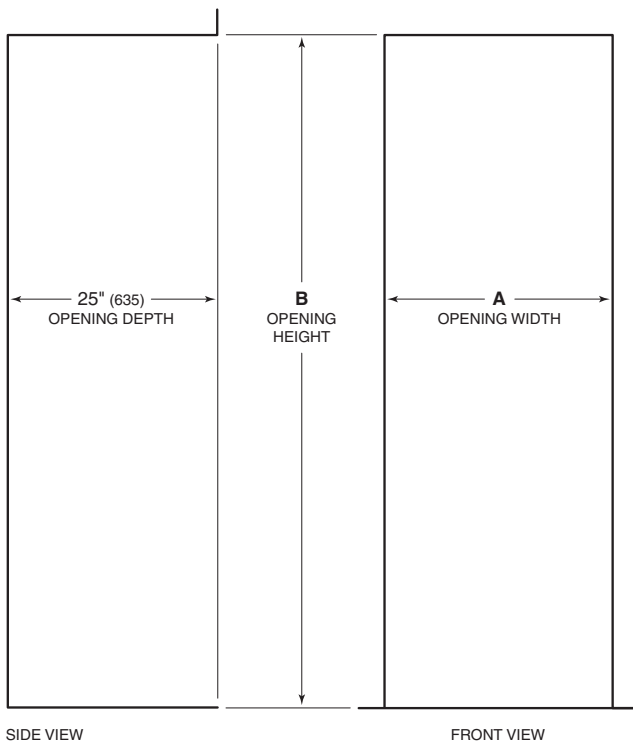

Opening Dimensions	A	B
IC-27R and IC-27FI	27" (686)	81" (2057)
700TR, 700TFI, 700TCI	27" (686)	80" (2032)
736TR, 736TFI, 736TCI	36" (914)	80" (2032)
700BR, 700BF(I), 700BC(I)	27" (686)	34 ¹ / ₂ " (876)

Electrical Requirements

The electrical supply should be located within the shaded area shown in the illustrations. Follow the National Electrical Code and local codes and ordinances when installing the receptacle. A separate circuit, servicing only this appliance, is required. A ground fault circuit interrupter (GFCI) is not recommended and may cause interruption of operation.

IMPORTANT NOTE: It is critical that the electrical outlet be located within the shaded area shown so it does not interfere with installation of the anti-tip bracket. It must be flush with the back wall and positioned with the grounding prong to the right of the thinner blades.

Electrical Requirements	
Power Supply	115 V AC, 60 Hz
Circuit Breaker	15 amp
Receptacle	3-prong grounding-type

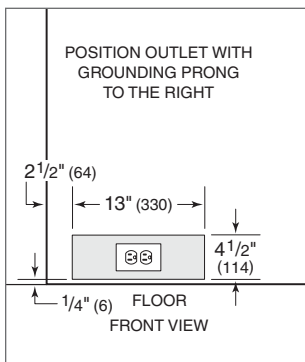

27" (686) models.

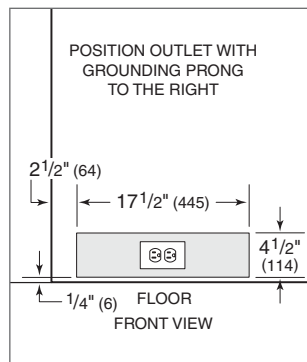

36" (914) models.

Plumbing Requirements

For integrated models with an automatic ice maker, the water supply line should be located through the floor or back wall, within the shaded area shown in the illustrations. The water supply line should be connected to the house supply with an easily accessible shut-off valve between the supply and the unit. Do not use self-piercing valves. A saddle valve kit (4200880) is available through your authorized Sub-Zero dealer.

IMPORTANT NOTE: It is critical that the water line be located within the shaded area shown so it does not interfere with installation of the anti-tip bracket.

An in-line filter is required when water conditions have a high sediment content. The ice maker operates on constant water pressure between 20 psi (1.4 bar) and 100 psi (6.9 bar).

IMPORTANT NOTE: In some cases, a reverse osmosis water filter system may not be able to maintain the minimum pressure consistently.

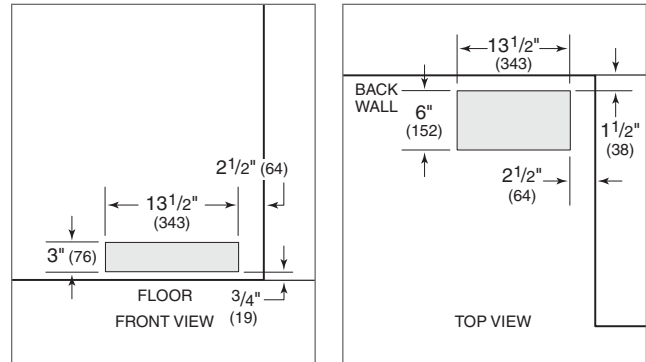

36" (914) models.

Plumbing Requirements	
Water Supply Line	1/4" OD copper line
Water Pressure	20–100 psi (1.4–6.9 bar)
Excess Water Line for Connection	27" (686)

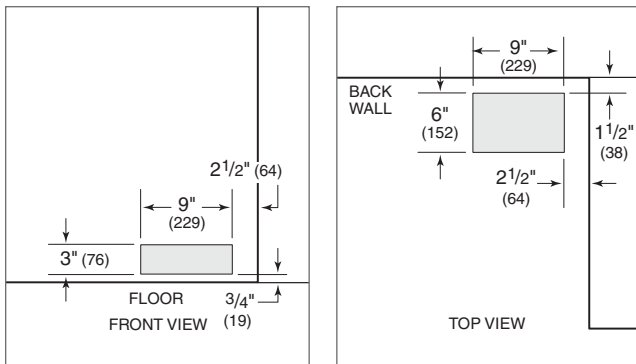

27" (686) models.

Cabinetry Applications

FRAMELESS CABINERY

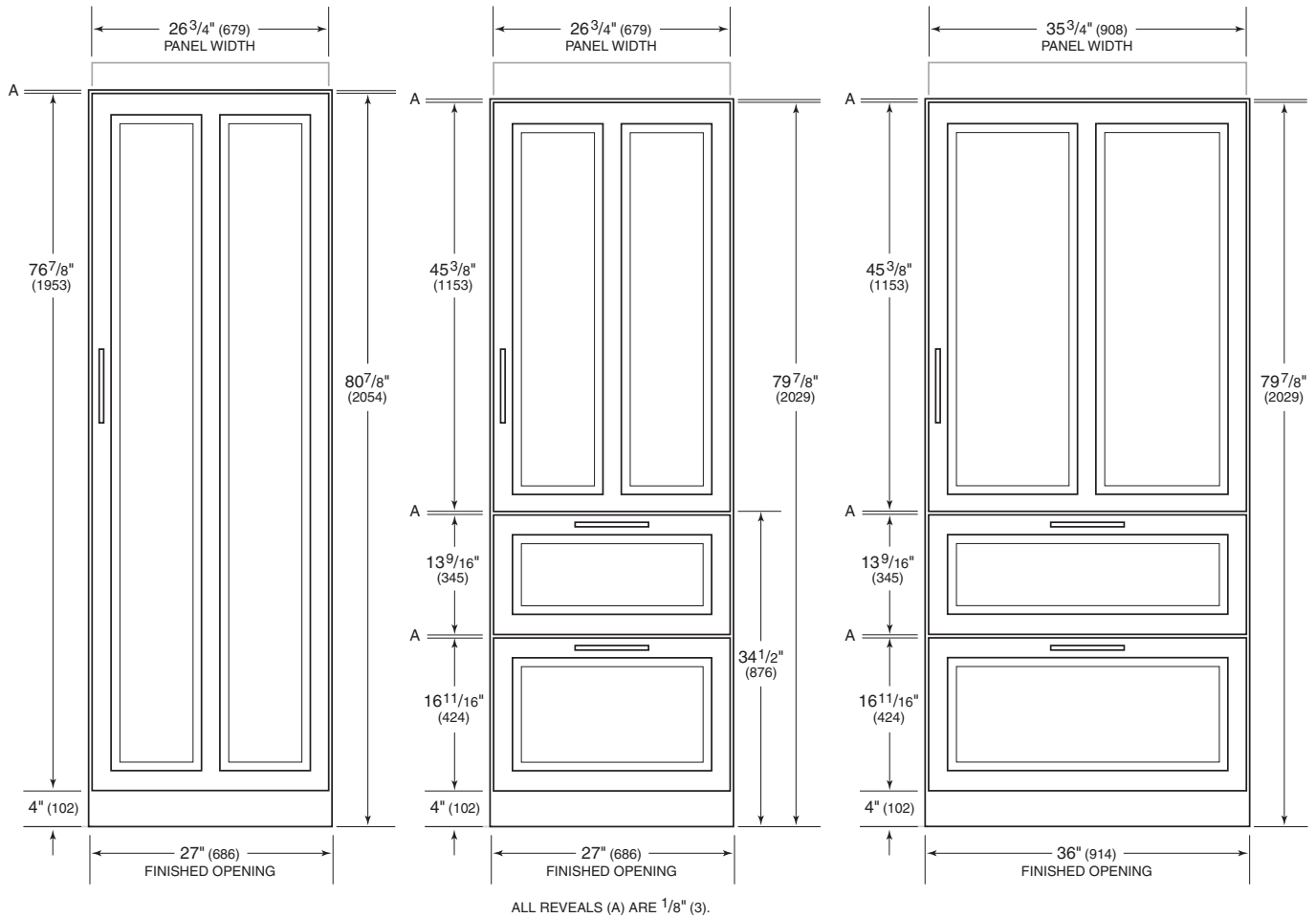

COLUMN MODELS

27" (686) MODELS

TALL AND DRAWER MODELS

36" (914) MODELS

TALL MODELS

Typical Panel Dimensions		
COLUMN MODELS		
	W	H
Door	26 ³ / ₄ " (679)	76 ⁷ / ₈ " (1953)
27" (686) MODELS		
	W	H
Door	26 ³ / ₄ " (679)	45 ³ / ₈ " (1153)
Top Drawer	26 ³ / ₄ " (679)	13 ⁹ / ₁₆ " (345)
Bottom Drawer	26 ³ / ₄ " (679)	16 ¹¹ / ₁₆ " (424)
36" (914) MODELS		
	W	H
Door	35 ³ / ₄ " (908)	45 ³ / ₈ " (1153)
Top Drawer	35 ³ / ₄ " (908)	13 ⁹ / ₁₆ " (345)
Bottom Drawer	35 ³ / ₄ " (908)	16 ¹¹ / ₁₆ " (424)

Panel dimensions are based on a 1/8" (3) reveal. A reveal of up to 1/4" (6) is possible with adjustments to panel dimensions.

Cabinetry Applications

DOOR PANEL HEIGHT

The height of the door panel can extend beyond the typical panel height, provided you do not exceed the panel weight limit. The illustration below shows how the panel may be extended and what you need to consider to finish the area behind the door panel.

IMPORTANT NOTE: The decorative valance used to finish the area behind the door panel must stay behind the front plane of the finished molding.

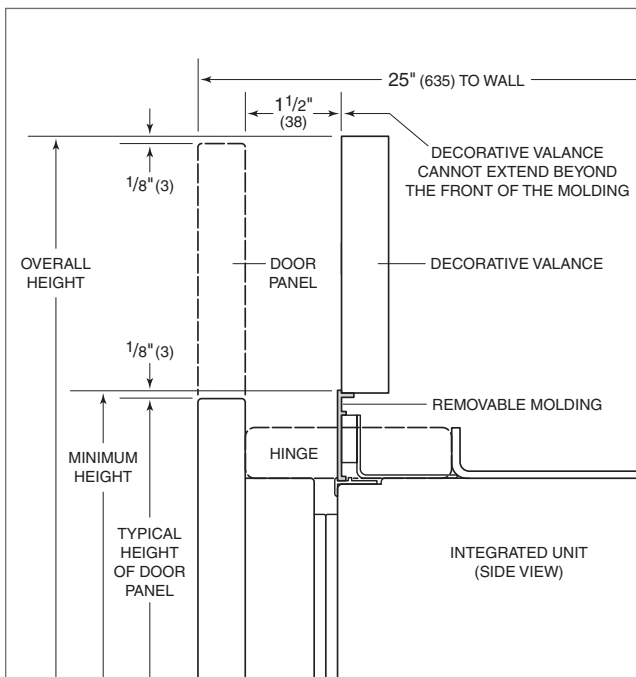

UPPER VALANCE
COLUMN AND TALL MODELS

TOE KICK CLEARANCE

The toe kick clearance can vary with the height of the panel. You must keep a minimum space of 4" (102) clear below the bottom edge of the panel for proper venting. In addition, any decorative base molding must be removable to clean the condenser and for service.

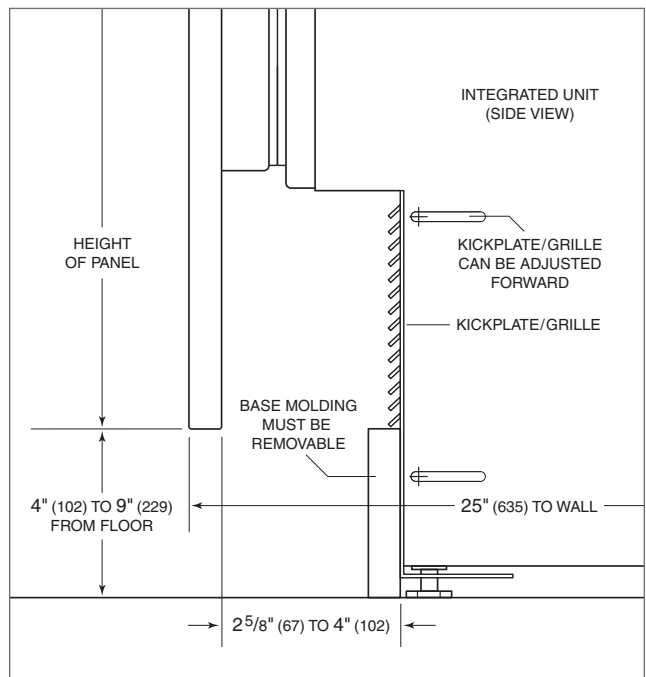

KICKPLATE/GRILLE AREA
ALL INTEGRATED MODELS

Cabinetry Applications

Integrated refrigeration is compatible with virtually any style and look of cabinetry. These models can be used with framed as well as frameless cabinetry. Because of the precise application and the look you may want to achieve, keep the following considerations in mind:

The thickness of the front panels can vary. A minimum 5/8" (16) thick panel is required, but the thickness can be increased provided the panel weight limit is not exceeded.

IMPORTANT NOTE: The depth of each integrated model is 24" (610) from the front of the unit to its back. You must allow for the thickness of the panel you are applying when planning for the finished rough opening depth if you want the front panel to be flush with surrounding cabinetry. You may have to move the unit back into drywall or bring the cabinets forward to achieve a flush fit.

Reveals between panels can vary. A reveal of 1/8" (3) is typical, but reveals can be increased to up to 1/4" (6).

⚠ CAUTION
As reveals between cabinetry and the unit decrease, the potential exists for severe finger pinching while the door is closing.

⚠ CAUTION
When 3/4" (19) or thicker panels are used with a reveal of less than 1/4" (6), door panels may cause damage to the unit when the door is opened to the maximum 105°. Use the built-in 90° door stop.

IMPORTANT NOTE: The inside edges of the rough opening as well as the sides and a portion of the backside of the decorative panels will need to be finished, as they will be exposed when the doors are open.

D-style handles are recommended. For the cabinet door, handles must be located near the edge of the panel opposite the hinge, centered top to bottom. Locate handles in the top center area of the drawer panels.

Illustrations on the following pages show typical applications of frameless and framed cabinetry. Also refer to the full-scale illustration at the end of this section for specifics on door openings.

Panel Requirements	
COLUMN MODELS	MAX WEIGHT
Door Panel	65 lbs (29 kg)
TALL AND DRAWER MODELS	MAX WEIGHT
27" (686) Door Panel	40 lbs (18 kg)
27" (686) Drawer Panel	12 lbs (5 kg)
36" (914) Door Panel	53 lbs (24 kg)
36" (914) Drawer Panel	16 lbs (7 kg)
PANEL THICKNESS	MINIMUM
All Panels	5/8" (16)

Cabinetry Applications

The illustrations below show typical applications of framed and frameless cabinetry. Refer to the full-scale templates at the end of this section for specifics on door openings.

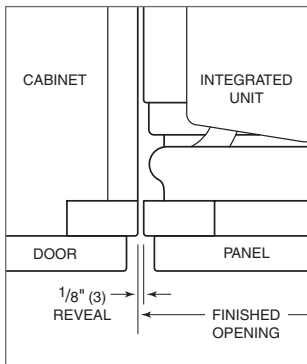

Framed—full overlay.

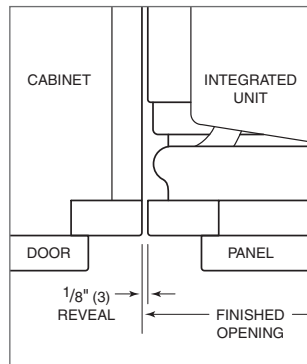

Framed—standard overlay.

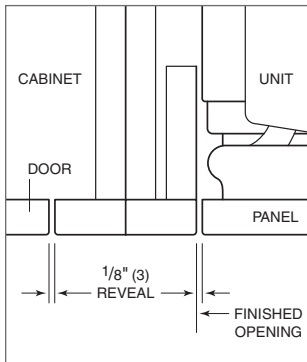

Framed—beaded inset.

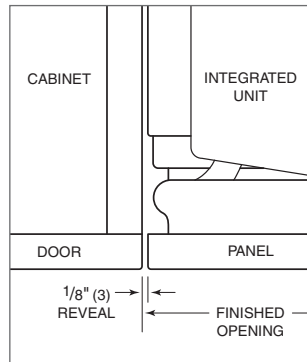

Frameless cabinetry.

Dual Installations

Two integrated units may be placed side by side in a dual installation. Panel width dimensions will vary slightly from single installations. Refer to the chart below for typical panel dimensions.

A dual installation kit is required for installations with 2" (51) or less space between the units. Dual installation kits are available through your authorized Sub-Zero dealer.

IMPORTANT NOTE: If a 27" (686) unit is installed next to a 36" (914) tall unit, the decorative front panels will align, however, the face frames will not. This is only apparent when both doors are open at the same time. Due to a more robust hinge on 36" (914) units, the face frame was reconfigured to maintain a consistent overall panel height.

Typical Panel Dimensions			
COLUMN MODELS		W	H
Door	26 ¹³ / ₁₆ " (681)	76 ⁷ / ₈ " (1953)	
27" (686) MODELS		W	H
Door	26 ¹³ / ₁₆ " (681)	45 ³ / ₈ " (1153)	
Top Drawer	26 ¹³ / ₁₆ " (681)	13 ⁹ / ₁₆ " (345)	
Bottom Drawer	26 ¹³ / ₁₆ " (681)	16 ¹¹ / ₁₆ " (424)	
36" (914) MODELS		W	H
Door	35 ¹³ / ₁₆ " (910)	45 ³ / ₈ " (1153)	
Top Drawer	35 ¹³ / ₁₆ " (910)	13 ⁹ / ₁₆ " (345)	
Bottom Drawer	35 ¹³ / ₁₆ " (910)	16 ¹¹ / ₁₆ " (424)	

Panel dimensions are based on a 1/8" (3) reveal. A reveal of up to 1/4" (6) is possible with adjustments to panel dimensions.

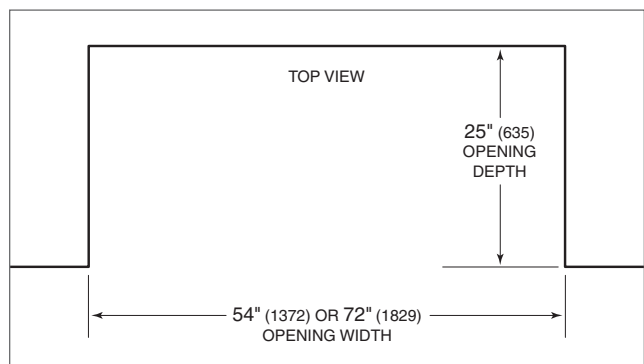

Dual installation opening.

Accessories

These optional accessories are available through your authorized Sub-Zero dealer. For local dealer information, visit the showroom locator section of our website, subzero.com.

- Stainless steel front panels with handles.
- Tubular and pro handles to match the style of Wolf ovens and ranges.
- Crisper drawer with shelf assembly, deli drawer with shelf and crisper cover with lid for certain models.
- Dual installation kit.
- Harness kit for Star-K compliance.

STANDARD HANDLE LENGTHS

Refer to the chart below for standard lengths of tubular and pro handles used on integrated models.

Standard Handle Lengths		
COLUMNS		DOOR
Tubular Handle		41 ⁷ / ₁₆ " (1053)
Pro Handle		39 ¹ / ₂ " (1003)
Stud Spacing		38 ³ / ₈ " (975)
27" (686) MODELS	DOOR	DRAWER
Tubular Handle	41 ⁷ / ₁₆ " (1053)	23" (584)
Pro Handle	39 ¹ / ₂ " (1003)	21" (533)
Stud Spacing	38 ³ / ₈ " (975)	19 ³ / ₄ " (502)
36" (914) MODELS	DOOR	DRAWER
Tubular Handle	41 ⁷ / ₁₆ " (1053)	32" (762)
Pro Handle	39 ¹ / ₂ " (1003)	30" (533)
Stud Spacing	38 ³ / ₈ " (975)	28 ³ / ₄ " (730)

Maximum Door Opening

FULL-SCALE TEMPLATE

If the panel is thicker than $\frac{3}{4}$ " (19), use the built-in 90° door stop to prevent damage to the panel and face frame at the maximum door opening.

